

**6<sup>th</sup> Annual  
Indiana University School of Medicine  
Education Day Program**

**Hine Hall Conference Center**

**Friday, April 25, 2025  
8:00 am – 5:00 pm**

***“Leadership and Mentorship in Medical Education”***



**INDIANA UNIVERSITY**  
SCHOOL OF MEDICINE



## 9:00 – 9:05 AM: WELCOME FROM DEAN ALLEN



**Bradley Allen, MD, PhD**  
Executive Associate Dean  
(Interim)  
Educational Affairs  
IUSM

Bradley Allen became the interim Executive Associate Dean for Educational Affairs in the fall of 2024, having been Senior Associate Dean for Medical Student Education since 2015. He's also the D. Craig Brater Professor of Professionalism and Professor of Clinical Medicine and Infectious Diseases. He joined IUSM faculty in 2000 and practices Infectious Diseases and HIV care at the Roudebush VA Medical Center.

He is a native Iowan, farm-boy, and first-generation university graduate. Brad is a University of Iowa graduate, with an MD/PhD in microbiology and later a fellowship in Infectious Diseases. He completed residency in Internal Medicine at Baylor College of Medicine in Houston.

He is co-PI on the INdiana Primary care Advancement in Clinical Training (INPACT) federal grant from HRSA to improve primary care training for underserved communities and vulnerable populations, expand recruitment of trainees and grow clinical training opportunities in underserved communities around Indiana.

## 12:00 – 12:45 PM: KEYNOTE SPEAKER



**Katherine Hiller, MD, MPH**  
Associate Dean and Director  
IUSM - Bloomington

Dr. Hiller is the associate dean and director of the IU School of Medicine Bloomington campus. She is a tenured professor of emergency medicine and holds the James A. Caplin Chair of Medicine. She is also a practicing emergency physician at the IU Health Bloomington hospital and chief academic officer for the South Region of IU Health. Dr. Hiller has been involved in undergraduate, graduate and continuing medical education; faculty development; and mentoring programs at the IU School of Medicine.

Dr. Hiller has extensively published high-quality medical education research, presented at numerous conferences, served as a medical expert for local media and acted as a principal investigator or collaborator on several grant-funded projects. Her educational work has included research around assessment in the classroom and clinical environments, programmatic assessment, curriculum development and faculty development and leadership. She has served on the boards of many national organizations, including the Clerkship Directors in Emergency Medicine, the National Board of Medical Examiners, the Association of American Medical Colleges and the American Board of Emergency Medicine.

She is a proud wife and mother of two children, and while medicine is not a popular topic of conversation at the Hiller household, education and math are favorite subjects for the entire family.



<b>6<sup>th</sup> IUSM Education Day Agenda</b> <b>Hine Hall, IU Indianapolis Campus</b> <b>Friday, April 25<sup>th</sup>, 2025</b>		
8:00-9:00 am	Hine Hall Slate Foyer	Registration
9:00-9:05 am	Hine Hall Auditorium	Welcome from Brad Allen, MD, PhD <i>Interim Executive Associate Dean Educational Affairs</i>
9:05-9:50 am	Hine Hall Auditorium	1 <sup>st</sup> Selected Oral Presentations
9:50-10:00 am		Break
10:00-10:45 am	Hine Hall Auditorium	2 <sup>nd</sup> Selected Oral Presentations
10:45-11:00 am		Break
11:00-11:45 am	Hine Hall (HH)	Concurrent Workshops (HH Rooms 216, 222, 226, 231, 232, 236)
11:45-12:00 pm		Break
12:00-12:45 pm	University Tower Ballroom	Lunch and Keynote Speaker (Katherine Hiller, MD, MPH)
12:45-1:00 pm		Break
1:00-1:45 pm	Hine Hall (HH)	1 <sup>st</sup> Concurrent Themed Oral Presentations: <ul style="list-style-type: none"> <li>■ <i>Creating Belonging in Medicine - Why Words Matter (HH Room 216)</i></li> <li>■ <i>Assessment (HH Room 219)</i></li> <li>■ <i>Wellness (HH Room 222)</i></li> <li>■ <i>Point of Care Ultrasound (HH Room 226)</i></li> <li>■ <i>Simulation (HH Room 231)</i></li> <li>■ <i>Artificial Intelligence in Medicine (HH Room 232)</i></li> <li>■ <i>Resident Patient Safety – I (HH Room 236)</i></li> </ul>
1:45-2:00 pm		Break
2:00-2:45 pm	Hine Hall (HH)	2 <sup>nd</sup> Concurrent Themed Oral Presentations: <ul style="list-style-type: none"> <li>■ <i>Graduate Medical Education (HH Room 216)</i></li> <li>■ <i>Biomedical Education (HH Room 219)</i></li> <li>■ <i>Simulation Center Collaborative Group (HH Room 222)</i></li> <li>■ <i>Regional Medical Campuses (HH Room 226)</i></li> <li>■ <i>Undergraduate Medical Education (HH Room 231)</i></li> <li>■ <i>Resident Patient Safety – II (HH Room 236)</i></li> </ul>
2:45-3:00 pm		Break
3:00-4:00 pm	Hine Hall Hallway	Poster Presentations (1 <sup>st</sup> floor) Scholarly Concentration Poster Presentations (2 <sup>nd</sup> floor)
4:00-5:00 pm	Hine Hall Auditorium Lobby	Reception and Certificates

**9:05 - 9:50 AM**

**1<sup>st</sup> SELECTED ORAL PLATFORM PRESENTATIONS**

**HINE HALL AUDITORIUM**

- **Evaluation of Altered Mental Status by Medical Students: How Does Bias Affect Decision Making?**  
*Malia Moore, Jonah Persinger, Rachel Day, Audrey Herbert, Dylan Cooper, Jennifer Deppen, Matthew Hays, Xiaochun Li, Ashley Satorius, Anna Bona, Katie Pettit*
- **Medical Students Want Asynchronous Content. But Do They Watch It? A Comparison of Viewership and NBME Data.**  
*Payton Miller, Megan Rendina, Folasade Imeokparia, Lindsey Mossler, Katie Stanton*
- **Factors Influencing Dictation Errors in Radiology Resident Reports: An Institutional Analysis**  
*Justin Smith, Grace Yedlicka, Allison Yang, Peter Gunderman*
- **Curricular Mapping for Sexual Health Competencies**  
*Brenda Anak Ganeng, Stephanie Freed, Jessica Byram*

**9:50 – 10:00 AM**

**BREAK**

**10:00 – 10:45 AM**

**2<sup>nd</sup> SELECTED ORAL PLATFORM PRESENTATIONS**

**HINE HALL AUDITORIUM**

- **Student Experiences on Required Regional Clinical Placements during Medical School**  
*Hannah O. Davis, Althea N. Kaminske, Cameron J. Edwards*
- **Fostering Belongingness in Clerkships: Insights from Third-Year Medical Student Reflections**  
*Jessica Byram, Neil Mehta, J. Harry Isaacson, Richard Frankel*
- **Enhancing Specialty Selection in Medical Education: A Scoping Review of Interventions in US Allopathic Medical Schools**  
*Anthony Shanks, Miriam Ramirez, Emily Walvoord, Judith Maddatu, Diana Arrocha, Bhavi Sarda, Amanda Benadaret, Debra Rusk*
- **Needs Assessment of a Minimally Invasive Gynecologic Surgery (MIGS) Curriculum: Perspectives of Recent OB/GYN Graduates**  
*Leah Bode, Alexandra Dadrat, Sara Spielman, MaKayla Picklesimer, Colette Gnade, Adeoti Oshinowo*

**10:45 – 11:00 AM**

**BREAK**

**11:00 – 11:45 AM**

**CONCURRENT WORKSHOPS**

**HINE HALL**

**HH ROOM 216**

- **Prompt Development 101 for Medical Educators**  
*Levi Dolan, Samar Khirallah, Andrew Cale, Anthony Shanks*

**HH ROOM 222**

- **AI at IUSM**  
*Dave Hanson, Ben Steckler*

**HH ROOM 226**

- **It's Never Too Early to Start: Let's Curate your Online Scholarly Presence for Residency Applications**  
*Hannah J. Craven, Anthony L. Shanks, Brandon T. Pieczko*

**HH ROOM 231**

- **Building Future Educators: Designing and Implementing a Teaching Assistant Elective Course**  
*Katie Stanton-Maxey, Lindsey Mossler, Sade Imeokparia, Anne Skiles, Cassey Krupa, Megan Rendina*

**HH ROOM 232**

- **Kudos! Faculty and Resident Teaching Development: A Carrot Approach**  
*Folasade Imeokparia, Meghan Rendina, Cassey Krupa, Anne Skiles, Lindsey Mossler, Katie Stanton-Maxey*

**HH ROOM 236**

- **Building a Culture of Growth and Safety: A Workshop on Positive Reinforcement, Mistreatment, and Psychological Safety**  
*Adriano Sanjuan, Jay Kishor Akolkar, Francesca Christina Duncan*

**11:45 – 12:00 PM**

**BREAK**

**12:00 – 12:45 PM**

**LUNCH & KEYNOTE SPEAKER**

**UNIVERSITY TOWER BALLROOM**

- **Keynote Speaker: Katherine Hiller, MD, MPH**  
*"Math is Perfect, Humans are Messy – My Journey in Medical Education"*

**12:45 – 1:00 PM**

**BREAK**

**1:00 – 1:45 PM**

**1<sup>st</sup> CONCURRENT THEMED ORAL PRESENTATIONS  
HINE HALL**

**CREATING BELONGING IN MEDICINE – WHY WORDS MATTER [HH ROOM 216]**

*Session Leader: Matthew Holley, PhD*

*Additional Contributors:*

- **An Equitable and Inclusive Language Workshop with Indiana LEND Trainees (Leadership Education in Neurodevelopmental Disabilities)**

*Asna Asrar, Areeba Kara, Krista Longtin*

- **Developing Relationship-Centered Communication and Allyship Skills via Active Learning Strategies**

*Katherine Chartier, Rachel Kowal, Sarah Walsh, Maryann Chimhanda, Brian Skillman, Matthew Holley*

- **How do Internal Medicine Residency Program Websites Signal their Inclusion to Prospective LGBTQIA+ Applicants?**

- *Will Gribbin, Brittany Baker, Ellen Peterson, Brenda Anak Ganeng, Jessica Byram*

**ASSESSMENT [HH ROOM 219]**

*Session Leader: Kathy Zoppi, PhD*

**WELLNESS [HH ROOM 222]**

*Session Leader: Heather Kelker, MD*

*Additional Contributors:*

- **Online Learning and Student Wellness in the Pre-clinical Curriculum**

*Leslie A. Hoffman, Ann Jones, Lisa McTavish*

- **The Mental Health and Well-Being of Residents and How They Relate to Program Specific Issues**

*Nathan Sevilla, Alejandro Garcia, Zachary Wagner, Lorena Juarez, Paola Rodriguez, Lourdes Izaguirre, Javier Sevilla, Anna Pendrey*

**POINT OF CARE ULTRASOUND – POCUS [HH ROOM 226]**

*Session Leader: Rob Ferre, MD*

*Additional Contributors:*

- **Evaluation of a Point of Care Ultrasound Active Learning Module for High School Student Outreach**

*Victoria L. Gomez, Elizabeth R. Agosto, Andrew S. Cale*

- **Establishing Competency in Point-of-Care Ultrasound in Nephrology Fellowship**

*Morgan Marcuccilli*

- **A Novel Approach to Point-of-Care Ultrasound (POCUS) Education: One-page Documents with Embedded E-Curriculum**

*Nathan Markus, Adriano Sanjuan, Eric Osborn, Edwin Jackson*

- **Development of a Point of Care Ultrasound Assessment Tool for Focused Cardiac Ultrasound**

*Frances Russell, Robinson Ferre, Nicholas Seitz, Parker Lewis, Dani Brenner, Audrey Herbert*



### **SIMULATION [HH ROOM 231]**

*Session Leader: Dylan Cooper, MD*

*Additional Contributors:*

- **Assessing Surgical Skills Lab Instruction**  
*Yichuan Yan, Althea Kaminske, Maya Hunt, E. Matt Ritter, Dimitrios Stefanidis*
- **Improving Fellow Research Study Design Skills and Confidence Through Gamification**  
*Anne Whitehead, Nathan Alves*
- **Virtual Reality Empathy Training**  
*Dylan Cooper*

### **ARTIFICIAL INTELLIGENCE IN MEDICINE [HH ROOM 232]**

*Session Leader: Anthony Shanks, MD*

*Additional Contributors:*

- **Reimagining Anatomy Education with Generative AI: A Student-Centered Exploration**  
*Victoria L. Gomez, Margaret A. McNulty*
- **Balancing Innovation and Ethics: Anatomy Students on Generative AI**  
*Victoria L. Gomez, Margaret A. McNulty*
- **Evaluation of AI Narrative Feedback for Gross Anatomy**  
*Samar Khirallah, Andrew Cale, Levi Dolan, Kyle Robertson*

### **RESIDENT PATIENT SAFETY - I [HH ROOM 236]**

*Session Leader: Tina Marie Schade-Willis, MD*

*Additional Contributors:*

- **Analysis of Barriers and Perceptions to In-Hospital Incident Reporting by IU Trainees**  
*Emily Lyons, Sara Manning*

**1:45 – 2:00 PM**

**BREAK**

**2:00 – 2:45 PM**

**2<sup>nd</sup> CONCURRENT THEMED ORAL PRESENTATIONS  
HINE HALL**

### **GRADUATE MEDICAL EDUCATION [HH ROOM 216]**

*Session Leader: Jennifer Choi, MD*

*Additional Contributors:*

- **Bridging the Research Gap: Developing Core Competencies and Research Culture in Internal Medicine Residency Training**  
*Mounir Al Gibbawi, Jennifer R. Hur, Sacha Sharp*
- **Evaluating Resident Competency in Leading Neonatal Resuscitation using a Validated Tool**  
*Margaret Gegick, Sara Kane*

- **Setting the Bar: Using EPAs to Define Competence for the Foundational Surgical Resident**  
*Maya L. Hunt, Payton M. Miller, Noosha Deravi, Dominique Doster, Yichuan Yan, Brianne Nickel, Dimitrios Stefanidis, E. Matthew Ritter*
- **Effects of Trainees on Faculty Clinical Productivity**  
*Peter Gunderman, Mason Tippy, Richard Gunderman, Tyler Avery*

#### **BIOMEDICAL EDUCATION [HH ROOM 219]**

*Session Leader: Tom Hurley, PhD*

*Additional Contributors:*

- **Introducing a Professional Development Skill Building Platform into a Biomedical Sciences Graduate Program Curriculum in Pharmacology**  
*Elizabeth Yeh*

#### **SIMULATION CENTER COLLABORATIVE GROUP [HH ROOM 222]**

*Session Leader: Dimitris Stefanidis, MD, PhD*

#### **REGIONAL MEDICAL CAMPUSES [HH ROOM 226]**

*Session Leader: Matthew Tews, MD*

*Additional Contributors:*

- **Scholarly Concentrations Program: Contributing to Student Satisfaction**  
*Deborah Birnbaum, Anthony Masseria, Michelle Marie Polanco*

#### **UNDERGRADUATE MEDICAL EDUCATION [HH ROOM 231]**

*Session Leader: Paul Ko, MD*

*Additional Contributors:*

- **Exploring First Year Medical Student Perceptions of a Vertically Integrated Anatomy Curriculum in Medical Education**  
*Robert Becker, Jessica Byram*
- **Can the Hidden Curriculum of Overnight Call for Third-Year Surgery Clerkship Students be Fulfilled during Daylight Hours?**  
*Noosha D. Deravi, Maya L. Hunt, Payton M. Miller, Katie Stanton-Maxey*
- **De-Mystifying the Surgery Clerkship Grade: Enhancing Transparency and Promoting Personal Improvement**  
*Folasade Imeokparia, Meghan Rendina, Casey Krupa, Anne Skiles, Lindsey Mossler, Katie Stanton-Maxey*

#### **RESIDENT PATIENT SAFETY - II [HH ROOM 236]**

*Session Leader: Tina Marie Schade-Willis, MD*

**2:45 – 3:00 PM**

**BREAK**

**3:00 – 4:00 PM**

**POSTER PRESENTATIONS**

**HINE HALL HALLWAY - 1<sup>ST</sup> FLOOR**

**ED 1. Perceptions, Experiences, and Attitudes of Health Professions Students in a Cadaver-Based Human Anatomy Educational Experience**

*Jose Mas, Baraka Muvuka, Michelle Beck, Caroline Boyle, Ronni Allen*

**ED 2. Development and Initial Evaluation of a Gross/Embryo Q-bank for Human Structure**

*Polly Husmann, Kyle Robertson, Leslie Hoffman, Abigail Sondreal, Brandon Flom, Tracy Vargo-Gogola*

**ED 3. Detergent, Foam & Candy: Evaluating a Novel Transition to Residency Cadaver Skills Curriculum**

*Maya L. Hunt, Payton M. Miller, Madeline B. Krusing, Noosha D. Deravi, Lindsey P. Mossler, Katie J. Stanton-Maxey*

**ED 4. Impact of an Introductory Session on Students' Attitudes and Emotions Toward Anatomical Donors and Cadaveric Dissection**

*Samar Khirallah*

**ED 5. Diagnosing the First Patient: Integrating Histopathology into an Undergraduate Gross Anatomy Course**

*Megan Kruskie, Jess Byram, Kyle Robertson*

**ED 6. Student Use and Perceptions of a Human Structure Anki Flashcard Deck**

*Leah J. Peipert, Abigail Sondreal, Brandon Flom, Kyle Robertson, Ike Izah, Leslie Hoffman, Polly Husmann, Tracy Vargo-Gogola*

**ED 7. The State of Human Skeletal Remains at U.S. Medical Schools**

*Sabrina Woods, Jessica Byram*

**ED 8. A Mini-Immersion Workshop in the Department of Pathology and Laboratory Medicine: An Intervention Designed to Address the Experiential Gap of Medical Students to the Field of Pathology**

*Rachel P. Kowal, Komal Kochhar, Krista J. Longtin, Matthew Kuhar, Anne Nguyen, Adeyinka Akinsanya, J.P. Lavik, Michael Feldman, Nicole LePage, Jessica Muldoon, Halimat Olaniyan, Joshua Kocemba*

**ED 9. The Peer Evaluation Tool: A Concurrent Validity Assessment**

*Jessica Byram, Elizabeth Agosto, Kyle Robertson*

**ED 10. Program-Weighted Situational Judgement Tests: Making Holistic Review More Evidenced Based and Manageable**

*Noosha Deravi, Madeline M. Blackwell, Brianne Nickel, Payton M. Miller, Maya L. Hunt, Dimitrios Stefanidis, E. Matthew Ritter*

**ED 11. Setting Standards for a Foundational Oral Exam within a Competency-Based Program of Assessment**

*Noosha Deravi, Christopher M. Thomas, Madeline Blackwell Krusing, Maya L. Hunt, Payton M. Miller, Dominique Doster, Yichuan Yan, Dimitrios Stefanidis, E. Matthew Ritter*

**ED 12. Examination of Procedures Performed by M3s During the IUSM Anesthesia Clerkship**

*W. Andrew Harvey, Lindsey N. Grabek, Tanna J. Boyer, Timothy T. Webb*

**ED 13. The Evolution of Surgical Approaches to Brachial Plexus Injury**

*Barnabas Obeng-Gyasi, Piiamaria Virtanen, Jackson Griffith-Linsey, Michael Sundahl, Jason Schwab, Jamie Bradbury*

**ED 14. Extracurricular Skills Development Through Neonatal Care Innovations**

*Carl Russell III, Neal Patel, Damen Wilson, Ben Johnson, Andrew Sivaprakasam, Conner Earl*

**ED 15. Medical Student Knowledge of Indiana Abortion Policy in the Post-Dobbs Era**

*Myanna Cook, Anslyn Freije, Anna Pressel, Erin O'Farrell, Anthony Shanks, Amy Caldwell*

**ED 16. Moral Formation in Medical Education: A Framework**

*Afsheen Mansoori, Aishat Audu, Richard Gunderman*

**ED 17. Identifying Student Perspectives and Needs on Institution-based Research Experiences**

*Noah Burket, Luke Jackson, Marie Karam, Ashlyn Morris, Anne Nguyen, Brittney-Shea Herbert*

**ED 18. Scholarly Medical Student Engagement in Public Health Research**

*Amanda D. Benaderet, Deborah R. Birnbaum, William M. Tierney*

**ED 19. Acute Compartment Syndrome: A Case Report for Pre-Clinical Students' Learning & Associated Small Group Worksheet**

*Kyle Callahan*

**ED 20. Utilization of Lecture-Based and Simulation-Based Teaching of Trauma-Informed Care in First-Year Medical Curriculum**

*Elizabeth Kerns, Elsie Gasaway, Geneva Baumberger, Polly Husmann*

**ED 21. Effects of Structured Curriculum and Simulation-Based Interventions on Pediatric Endoscopy Education**

*Brett J. Hoskins*

**ED 22. Additional Validity Evidence for the New ENDO Mentor Suite and its Use in the Fundamentals of Endoscopic Surgery Examination**

*Noosha D. Deravi, Payton M. Miller, Maya L. Hunt, Jessica Mischna, Jose M. Martinez, Eric Pauli, E. Matthew Ritter*

**ED 23. Development of a Point-of-Care Ultrasound Training Curriculum the IUSM Anesthesia Clerkship**

*Timothy T. Webb, Tanna J. Boyer, Lindsey Grabeck, W. Andrew Harvey, Johnny Cartwright, Chris Moore, Melissa A. Nobbe, Sally A. Mitchell*

**ED 24. Developing a Musculoskeletal Ultrasound Curriculum for Internal Medicine Residents**

*Rachna Chaudhari, Reid Wilson, Meredith Ventura*

**ED 25. Leveraging Advanced Cardiac POCUS in the Diagnosis of Infective Endocarditis with Negative Conventional Imaging: A Case Report**

*Adriano Sanjuan, Heather Andrade, Alyson Bundy, Philip Clapham, Nathan Markus, Daniel S. Brenner, Irina K. Hariri, Edwin Jackson*

**ED 26. Gastric Ultrasound Education: Participant Survey Data from a Statewide Gastric POCUS Workshop**

*Nicole Bianca Libiran, Azam Mohammed, Brandon Tanner, Tanna Boyer, Senthil Packiasabapathy*

**ED 27. C.A.M.E.R.A.: Communication Assistance and Mentoring in Electronic Residency Applications**

*Erica Swanson, Aniffa Kouton, Deja Miller-Brooks, Wen J. Chen, Corinna Yu*

**ED 28. Impact of Residency Curriculum and Individual Resident Characteristics on Primary Care Careers**

*Lauren Carpenter, Michael Wilson*

**ED 29. Improving Cancer Screening Rates Through Resident-led Teaching Initiative at a VA Primary Care Clinic**

*Paresh Kumar, Kassy Kneen, Trevor Lehr*

**ED 30. A Workshop Series for New Program Directors - Lessons Learned?**

*Christen Dilly, Jennifer Choi, Phillip Pham*

**ED 31. Predicting Surgical Leadership: More Than Institutional Pedigree**

*Maya L. Hunt, Qais AbuHasan, Noosha Deravi, Payton Miller, Hermona Abera, Keith Makhecha, Rafia Durrani, Brianne Nickel, Dimitrios Stefanidis, E. Matthew Ritter*

**ED 32. Know Before You Go: Evaluating the Utility of Pre-Departure Training for Internal Medicine Residents Prior to an International Elective**

*Grace Arias, Goble Gretchen, Corinne Thornton*

**ED 33. Assessment and Implementation of Preconception Training for Internal Medicine Residents**

*Allison Knoedler, Erica Swanson*

**ED 34. Video-Based Assessment for Laparoscopic Fundoplication: Validity Evidence for Rater Training among Surgical Trainees**

*Noosha D. Deravi, Dylan Grisell, Aimee K. Gardner, Marina S. Kurian, Anna R. Ibele, Nova Szoka, Linda Schultz, Liane S. Feldman, E. Matthew Ritter*

**ED 35. Best Practices for Balancing Inquiry and Efficiency on a Gastroenterology Consult Survey: Outcomes of a Delphi Survey**

*Natashay J. Bailey, Christen Dilly*

**ED 36. Exploring Ownership Structures in Radiology Residency**

*Molli Fromke, Tina Ahmadi, Peter Gunderman*

**ED 37. Reappraising Resident Hematopathology Training at Indiana University**

*Halimat Olaniyan, Adeyinka Akinsanya, Rohit Gulati*

**ED 38. Effect of Pre-clinical Patient Exposure on US Medical Student Bias Towards Mental Health**

*Lauren Bryant, Alyssa Smith, Micah Iticovici, Lindsey d'Arnaud, Donbing Lai, Nermeen El-Araby, Ifeoluwa Ladapo, Mario Padron, Nazli Tunali, Sydney Waller, Joseph McCann, Martin Palwecki*

**ED 39. Mission Impossible: Program Directors on Improving Resident Well-Being**

*Maya L. Hunt, Daniela Amórtégui, Ray T. Ramirez, Jr., Natalia I. Mackiewicz, Amy L. Holmstrom, Karl Y. Bilimoria, Julie K. Johnson, Yue-Yung Hu*

**ED 40. Harnessing Applied Improvisation to Restore Empathy and Connection in Stressed Emergency Departments (HarRiED)**

*Elizabeth Weinstein, Jeff Heerdink-Santos, Krista Longtin*

**ED 41. Year 1 Academic Outcomes for Medical Students Participating in a Pre-Matriculation Program**

*Althea Kaminske, Jasmine Johnson, Chemen Neal*

**ED 42. Performance in Year 1 Anatomy Course for Medical Students Participating in a Pre-Matriculation Program**

*Jasmine Johnson, Althea Kaminske, Jessica Byram, Margaret McNulty, Chemen Neal*

**ED 43. Accommodating a Student with Hearing Impairment in Pre-Clinical Medical Education**

*Angelika I. Martin, Leslie A. Hoffman, Abigail Russell*

**ED 44. Family Planning Exposure on the OBGYN Clerkship in the Indiana Post-Dobbs Era**

*Myanna Cook, Anslyn Freije, Anna Pressel, Erin O'Farrell, Anthony Shanks, Amy Caldwell*

**ED 45. Improving Health and Well-Being of Older Adults in Underserved Communities: A Global Perspective**

*Anna Pendrey, Paola Castellanos, Lorena Juarez, Paola Rodriguez, Hector Mendoza, Lourdes Izaguirre, Nathan Sevilla, Mariela Sanchez, Alejandro Garcia, Javier Sevilla*

**ED 46. Building the Foundation: Assessing Health Literacy in Santa Cruz de Yojoa, Honduras**

*Alexa Engel, Lesbin Javier Velsásquez Lopez, Sharon Joseph, Jacob Olson*

**ED 47. IUSM Continuing Education in Healthcare Professions (CEHP) Fostering Cross-Departmental Collaboration Through Innovative Specialized Education Design**

*Breann Bauer, Rima Patel, Kim Denny, Jennifer E. Schwartz*

**ED 48. CEHP Program-Based Analysis of Accreditation Evaluation Criteria**

*Kim Denny, Jeff Lawley, Jennifer Schwartz*

**3:00 – 4:00 PM**

**SCHOLARLY CONCENTRATION POSTER PRESENTATIONS**

**HINE HALL HALLWAY - 2<sup>ND</sup> FLOOR**

**SC 1. Psychosocial Barriers to Equitable Food Access: A Qualitative Analysis of Food Pantries in Northern Indiana**

*Christopher J. Abrinko, Morgan C. Lain, Mahmoud D. Al-Fadhli, Caymah F. Dennis, Madeline G. Andrews, David Lassen*

**SC 2. Sociodemographic Disadvantaged Adolescent Attitudes on Healthy Lifestyle Education: Variances with Career Choice**

*Jocelyn Chang-Stroman, Gionté Mason, Amy Han, Tatiana Kostrominova*

**SC 3. Association of Socio-Demographic Factors and Social Determinants of Health with Physical Activity Level in Patients with Disabilities**

*Austin Clark, Baraka Muvuka, Jonathan Guerrero, Joshua Mangum*

**SC 4. Food Pantry Nutritional Food Acquisition and Distribution Assessment in the Greater St. Joseph Country Area**

*Mackenzie Johnson, Joshua Scott, JR Bales, Claire Harper*

**SC 5. Socio-Demographic and Behavioral Predictors of Ophthalmic Readmissions in Northwest Indiana**

*Grace Armstrong, Neon Calumpang, Jonathan Guerrero, Baraka Muvuka*

**SC 6. Impact of Social Determinants of Health on Stroke Severity in the Northwest Indiana Region**

*Jacobus Barnard, David Lin, Grace Armstrong, Neon Calumpang, Miranda Cash, Amy Han*

**SC 7. Social Determinants of 30-Day Readmissions in Congestive Heart Failure: The Role of Food Insecurity**

*Alison Blodgett, Jonathan Guerrero, Baraka Muvuka*

**SC 8. Impact of Race and Industry on Stroke Incidence on Patients in Northwest Indiana – A Report to Advocate for Targeted Community-Based Interventions**

*Miranda M. Cash, Sahar A. Abdullah, Amy Han*

**SC 9. Social Determinants of Health and Their Effects on Readmission and 30-Day Readmission in Patients with a History of Cardiovascular Interventions**

*Mark Delos Reyes, Baraka Muvuka, Jonathan Edward Guerrero*

**SC 10. Social, Demographic, and Behavioral Determinants of Prolonged Hospital Stay and Readmissions of Postoperative Complications in an Urban Acute Care Hospital**

*Alexis Dres, Skyler Thompson, Maggie Sullivan, Baraka Muvuka, Jonathan Guerrero, Joshua Mangum, Kyle Gospodarek*

**SC 11. The Psychological Costs of Incarceration: Exploring the Development and Consequences of Post-Incarceration Syndrome**

*Ashley Egler, Elizabeth Nelson*

**SC 12. Decreased Racial Disparities in Sepsis Mortality after an Order Set–Driven Initiative: An Analysis of 8151 Patients**

*Maria L. Fernandez Olivera, Carl Pafford, Thomas Lardaro, Steven K. Roumpf, Michele Saysana, Benton R. Hunter*

**SC 13. Impact of Social Determinants of Health on Stroke Severity in the Northwest Indiana Region**

*Jacobus Barnard, David Lin, Grace Armstrong, Neon Calumpang, Miranda Cash, Amy Han*

**SC 14. Adult-Onset Cystic Fibrosis in a Spanish-Speaking Immigrant: Diagnostic Challenges and Barriers to Care**

*Alexa Mederos, Evelyn Crowley, Katie Rusiniak, Elijah Williams, Maria Parker Spector Robles*

**SC 15. Social Determinants of Inequities in Neurodegenerative Disease Readmissions in Northwest Indiana: An Advocacy Opportunity**

*Neon Calumpang, Grace Zhou Armstrong, Jonathan Guerrero, Baraka Muvuka, Kyle Gospodarek*

**SC 16. Cognitive and Behavioral Problems in Children with Uncomplicated and Asymptomatic Malaria in Low- and Middle-Income Countries: A Systematic Review and Meta-Analysis**

*Andrew Ssemata, Melissa Thomas, Paul Bangirana, Noeline Nakasujja, Ziyi Yang, Josey Noel, Chandy John, Megan McHenry*

**SC 17. Clinician Perspectives on Barriers and Facilitators to Providing Medications for Opioid Use Disorder for Adolescents in Indiana: A Qualitative Study**

*Jayla Ruth, Samantha Wagner, Matthew Aalsma, Zachary Adams, Lauren Bell*

**SC 18. An Analysis of Telehealth in a Post-Pandemic Rural, Midwestern Community: Increased Comfort and a Preference for Primary Care**

*Chase Salmon, Kameron Bell, Robin Danek, Eric Reyes, Ellen Ireland*

**SC 19. Racial and Ethnic Disparities in the Receipt of Regional Anesthesia for Surgical Interventions: A Narrative Review**

*Angad Sidhu, Marianne Matthias*

**SC 20. A Quantitative Evaluation of Community-based Educational Programming on African American Infant Mortality**

*Sheila Abebe, Kalyn M. Renbarger, Jean Marie S. Place, Avery Dawes, Olivia Huffman, WaTasha Barnes Griffin, Gabriel Hall, Adam Kroot, Tracina Greenleaf*

**SC 21. A Review of Best Practices in Recruitment of Individuals for Qualitative Studies from Marginalized Populations**

*Evan Barnett, Gregory Carter, Tyte Julian*

**SC 22. Training, Effectiveness, and Barriers for Pharmacists in Implementing Tobacco Cessation Interventions during Vaccine Administration**

*David Randall, Haleigh Kampman, Nervana Elkhadragey, Katy Hilts*

**SC 23. Understanding Variability in Long-Term Psychological Adjustment of Prelingually-Deaf Young Adults Implanted During Childhood**

*William G. Kronenberger, Irina Castellanos, Morgan A. Kincaid, Rick F. Nelson, Charles W. Yates, Susan T. Sehgal, Allison M. Ditmars, Carolyn J. Herbert, David B. Pisoni*

**SC 24. Vaping Addiction and Preventative Education (V.A.P.E): An Assessment of Electronic Cigarette Smoking in Adolescents**

*John Strobel, Zachary McLain, Lynn Witty, Larry Fromm*

**SC 25. Collaborative Opportunities for Teachers to Increase Adaptability of School-Based Sexual Health Education**

*Natalie Myers, Alison Greene, Catherine Sherwood-Laughlin, Lisa Greathouse, Ivanka Simic Stanojevic, Angela Chow, Dechen Sangmo, Mika Baugh, Wendy Schroder, Jordyn Galyan*



**SC 26. Barriers to Medicaid Enrollment and Healthcare Access for Hispanic/Latinx Populations in Hamilton County, IN**

*Lauren Earhart, James Medernach, Niki Messmore*

**SC 27. Seeing Eye-to-Eye: The Ethical Dilemma of Medicaid Refusal in Pediatric Ophthalmology**

*Margaret Tharp, Emily Beckman, Jane Hartsock*

**SC 28. Time-Driven Activity-Based Costing Analysis in Total Knee Arthroplasty**

*Iyad Ali, Rory Sandberg*

**SC 29. Effects of Functional Myofascial Release Therapy on Shoulder Range of Motion in a Collegiate Pitcher: A Case Report**

*Ryan Heumann, Matthew Waltz, Marcel Garcia-Hosokawa, Arthur Chlebowski*

**SC 30. Exploring the Correlation Between Time to Total Joint Arthroplasty and Depression Diagnosis in Obese Osteoarthritis Patients Using Real-World Database**

*Keegan Leek, Meagan McNicholas, Michael S. Roscoe, Arthur L. Chlebowski*

**SC 31. Predictors of Mortality and Hospital Length of Stay in Older Hip Fracture Patients in a Rural Community**

*Gabrielle Lutz, Thein Zhu*

**SC 32. Complications and Outcomes Associated with Two-Stage Treatment of Periprosthetic Knee Infection**

*Jacob Thomas, Mary Ziemba-Davis, Leonard T. Buller, R. Michael Meneghini*

**SC 33. Social Deprivation Index and Outcomes After ST-elevation Myocardial Infarction**

*Aditya Belamkar, Asad Torabi, Joshua Davis, Wesley Anderson, Elizabeth Von Der Lohe, Richard Kovacs, Rolf Kreutz*

**SC 34. Comparison of Endotracheal Tube vs. I-Gel Placement during Cardiac Arrests in Rural and Urban Settings: An EMS Personnel Survey**

*Kameron Bell, Chase Salmon, Eric Reyes, Robin Danek, Ellen Ireland*

**SC 35. Impact of Anticoagulant and Antiplatelet Medications on Operative Cost in HoLEP Patients**

*Cameron McClaine, Thomas Murphy, Abigail Beard, Thomas Shelton, Marcelino Rivera*

**SC 36. Role of Heterozygous PAI-1 Deficiency in Pathological Aging in the Human Cardiovascular System**

*Allison Nelson, Douglas Vaughan, Benjamin Żywicki*

**SC 37. Maximal Oxygen Uptake and Coronary Artery Calcium Scores in Firefighters**

*Hallie Waters*

**SC 38. Using Botulinum Toxin for the Treatment of Gastroparesis (GP) Post Gastric Peroral Endoscopic Myotomy (GPOEM)**

*Amr Kais, Mohamed Al-Haddad*

**SC 39. Evaluating the Role of Pretherapy Scans in Post-Thyroidectomy Thyroid Cancer Management: Predictive Value, Management Impact, and Efficacy**

*Yousif Mukatash, Mark Tann*

**SC 40. Awake Endoscopy with Advanced Programming to Optimize Hypoglossal Nerve Stimulation**

*Troy Wesson, Mohamad Z. Saltagi, Shalini Manchanda, Stephanie Stahl, Yelena Chernyak, Noah Parker*

**SC 41. Deficiencies in Capacity Documentation for Against Medical Advice Discharges: A Retrospective Cross-Sectional Review**

*Justin Barnett, Erin Brown, Joseph Cooper, Alyssa Smith, Emily Holmes*

**SC 42. The Wastes of the Operating Room**

*Youngjun Woo, Jonathan Arnold*

**SC 43. Objective Assessment and Scoring of Parkinsonian Tremors using Wrist Sensor Technology**

*Megan Sullivan, Aditya A. Shanghavi, Oliwia Rentley, Sarah Elizabeth Zauber, Anne B. Sereno*

**SC 44. A Human iPSC model of Alzheimer's Disease-Associated Fractalkine Receptor Polymorphism to Assess Microglial Dysfunction**

*Kaylee D. Tutrow, Jade Harkin, Catia Gomes, Melody Hernandez, Teresa Gomez, Kang-Chieh Huang, Yue Fang, Chi Zhang, Kate Cowger, Stephanie Bissel, Shweta Puntambekar, Bruce T. Lamb, Jason S. Meyer*

**SC 45. Phenotyping a Variant Associated with Pontocerebellar Hypoplasia 1B: RNA-Protein Discordance in a Rare Neurodegeneration-Related RNA Exosome Mutation**

*H.R. Sagara Wijeratne, Avery Runnebohm, Whitney Smith-Kinnaman, Emma H. Doud, Stephane Pelletier, Amber L. Mosley*

**SC 46. Developing a Tool to Assess Needs of AYA Cancer Survivors in Southwest Indiana**

*Brittany Ritzman, Joseph Sakel, Precious Okoruwa, Bridget Hawryluk, Lisa Parks, Dustin Lynch, Courtney Moore, Andrea Kiser, Brandon Cockrum, Ryan Heumann, Ellen Denning, Sarah Doherty, Austin Fonseca, Tessa Hemmerlein, Olwen Menez, Abigail Miller, Jessica Miller, Taylor Prechtel, Ross Quick, Ibrahim Rehman, Anjali Sivamohan, Aditi Sood, Hope Tominack, Sarah Wiehe, Kara Garcia, Tammy Sajdyk*

**SC 47. The Impact of Covid-19 on Implantable Cardioverter Defibrillator Implantation in Heart Failure Patients with Reduced Ejection Fraction**

*Emily Ryan, Rebecca Sparks-Thissen, Adrian Singson*

**SC 48. Elevated Levels of PDGF-BB and VEGF are Associated with a Decreased Risk of Readmission or Death in Children with Severe Malarial Anemia**

*Mary Slaughter, Samina Bhumbra, Kagan Mellencamp, Ruth Namazzi, Robert Opoka, Chandy John*

**SC 49. Fast-Fourier Transform - Transfer Function Analysis of Beat-to-Beat Finger Skin Blood Flux and Arterial Blood Pressure may provide New Insights into Cold-Induced Vasodilation**

*Thad E. Wilson, John A. Stout, Kristen Metzler-Wilson*

**SC 50. The Altered Vascular Endothelial Control of Facial Cutaneous Blood Flow in Rosacea**

*C. Ungureanu, Megan Kube, Thad Wilson, Kristen Metzler-Wilson*

**SC 51. Reanalysis and Reclassification of UBA2 Variants in Patient with Syndactyly, Polydactyly, Aplasia Cutis Congenita and Other Anomalies Reveals Diagnosis**

*Khurram Liaqat, Kimberly Felipe, Kayla Treat, Molly McPheron, Erin Conboy, Francesco Vetrini*

**SC 52. The Role of SHROOM3 in Congenital Heart Disease**

*Grant Hammons, Ally Aldrich, Rebecca Douglas, Catherine Guilfooy, Nina J. Jain, Ashleigh McMullan, Princess Murray, Caelen Rathke, Mark Wakulchik, Ellen Voskoboynik, James B. Zwierzynski, Stephanie Ware, Matthew Durbin*

**SC 53. UGT2B10 Variant Effects on Dexmedetomidine Metabolism Using Nicotine Studies**

*Cassidy Hardin, Aislinn O'Kane, Sara Quinney*

**SC 54. Examination of the Effects of Thrombopoietin Mimetic Peptide (TMP) and High-Fat Diet on Femur Fracture Healing**

*Saveda K. Majety, Samuel Zike, Danielle E. Hanna, Caio de Andrade Staut, Vincent Alentado, Sarah Mostardo, Murad Nazzal, Rachel Blosser, Sonali Karnik, Patrick Mulcrone, Melissa A. Kacena*

**SC 55. Synergy between Formal and Informal Business Education**

*Abigail Beard, Yo Sup Kim, Richard Gunderman*

**SC 56. Medical Student Attitudes Regarding Dual-Degree Programs**

*Frank Dijak, Komal Kochhar*

**SC 57. Preclinical Medical Student Perceptions of Two Exam Feedback Approaches**

*Elsie Gasaway, Valerie O'Loughlin*

**SC 58. Impact of Indiana University School of Medicine's Service-Learning Experience in the Dominican Republic on Medical Students**

*Ethan Goins, Niki Messmore, Ray Munguia*

**SC 59. Impact of Point-of-Care Ultrasound on Patient-Family Experience in a Pediatric Emergency Department: A Randomized Control Trial Assessment**

*Samuel Gutierrez, Pamela Soriano, Frances Russell, Benjamin Nti*

**SC 60. Celiac Disease in Medical Curriculum**

*Elizabeth Kerns, Polly Husmann*

**SC 61. Investigating Declining Physician Engagement in West-Central Indiana State Medical Association**

*Brianna Lawrence, Luke Swartz, Robert Ehresman*

**SC 62. Through a Different Lens: Assessing Patient and Clinician Diversity in Medical Education Clinical Practice Media**

*McKenna Major, Stacey Dunham, Valerie O'Loughlin*

**SC 63. Promoting Healthcare Careers for Minority Adolescents from the City of Gary**

*Gionté Mason, Jocelyn Chang-Stroman, Amy Han, Tatiana Kostrominova*

**SC 64. Exploring Motivations for a Career in Geriatrics**

*Mary O'Connor, Kathleen Unroe, Joe Kotva*

**SC 65. A Mixed-Methods Study Assessing Experienced Basic Needs Insecurity in Medical Students**

*Oseme Precious Okoruwa, Keyshla Chacon Nieves, Niki Messmore*

**SC 66. Resident Participation in Rural Rotations in Emergency Medicine Residency Programs**

*Kayley Ryan, Aloysius Humbert, Christine Motzkus*

**SC 67. The Impetus for Physician Advocacy**

*Eli Schantz*

**SC 68. Pathway of Military Medical Advancements from the Field to Widespread Adoption**

*William Stanton*

**SC 69. Assessment of AI (Artificial Intelligence) Based Facsimile Sorting System**

*Gabriel Araya, Arthur Chlebowski*

**SC 70. Gender Bias in Artificial Intelligence-Written Letters of Reference for Otolaryngology Residency Candidates**

*Grace Young, Janice Farlow, Heather Edwards, Linda Yin, Rusha Patel, Marianne Abouyared, Alexandra Kejner*

**SC 71. Competition and Collaboration in Medical School: Comparing Pass-Fail and Graded Systems**

*Tyler Dietzel, Blake Jarosinski, Brianne Brenneman*

**4:00 – 5:00 PM**

**RECEPTION & CERTIFICATES**

**HINE HALL AUDITORIUM LOBBY**



### **PLANNING COMMITTEE**

Komal Kochhar, MBBS, MHA (Chair)

Leslie Hoffman, PhD

David Rodgers, EdD

Dimitrios Stefanidis, MD, PhD

Bradley Allen, MD, PhD

### **ACKNOWLEDGEMENTS**

Continuing Education in Healthcare Professions (CEHP): Heather Hollcraft and CEHP Team  
Research in Medical Education (RIME) Team

### **SPECIAL THANKS**

To IUSM faculty who served as abstract reviewers

## CONTINUING MEDICAL EDUCATION LEARNER INFORMATION

### Course Objectives

- Identify examples of best practices in medical education
- Recognize the current approaches to assessing and evaluating learners
- Describe how educational outcomes data can be presented and published
- Network and collaborate with educators from other IUSM departments and campuses

### Accreditation Statement



In support of improving patient care, Indiana University School of Medicine is jointly accredited by the Accreditation Council for Continuing Medical Education (ACCME), the Accreditation Council for Pharmacy Education (ACPE), and the American Nurses Credentialing Center (ANCC), to provide continuing education for the healthcare team.

### Physicians

Indiana University School of Medicine designates this live activity for a maximum of 5.5 *AMA PRA Category 1 Credits™*. Physicians should claim only the credit commensurate with the extent of their participation in the activity.

## University Tower

# FIRST FLOOR

## Hine Hall

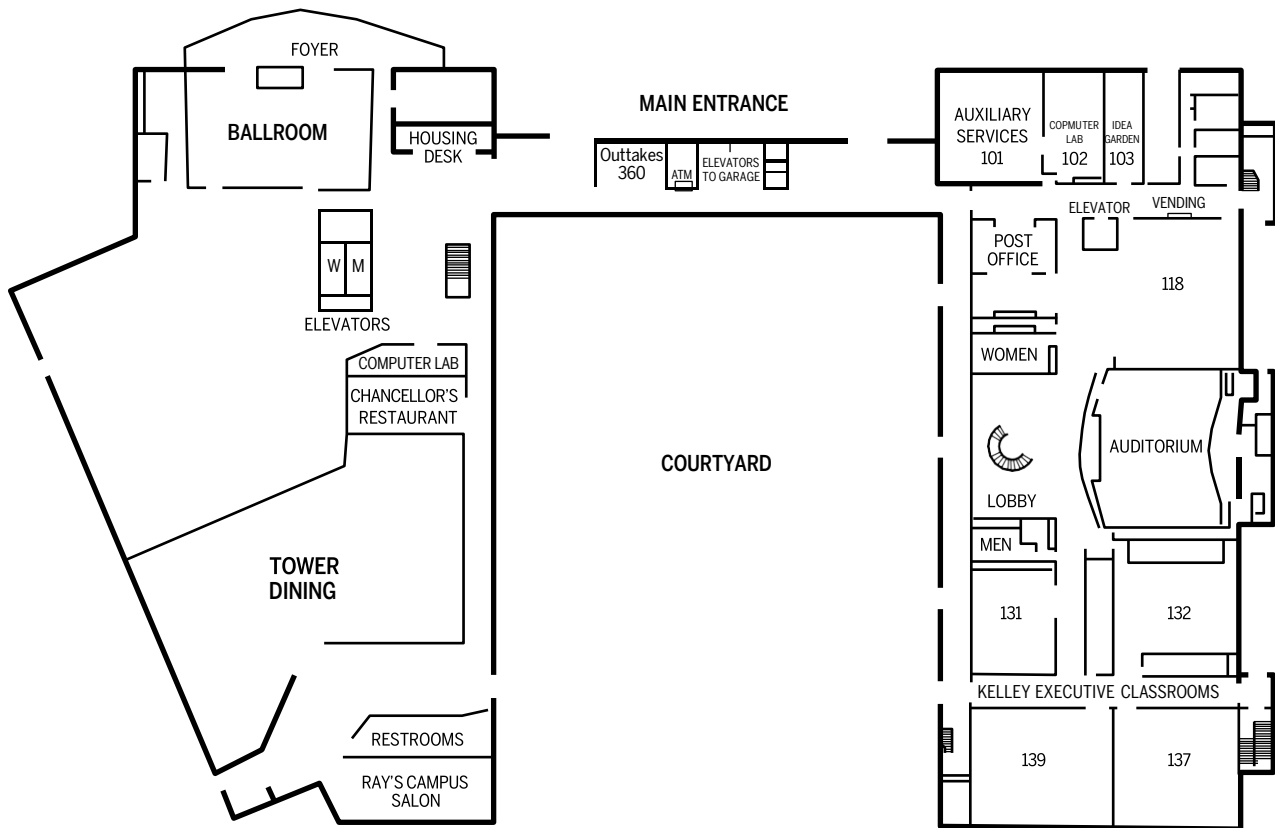

## University Tower

# SECOND FLOOR

## Hine Hall

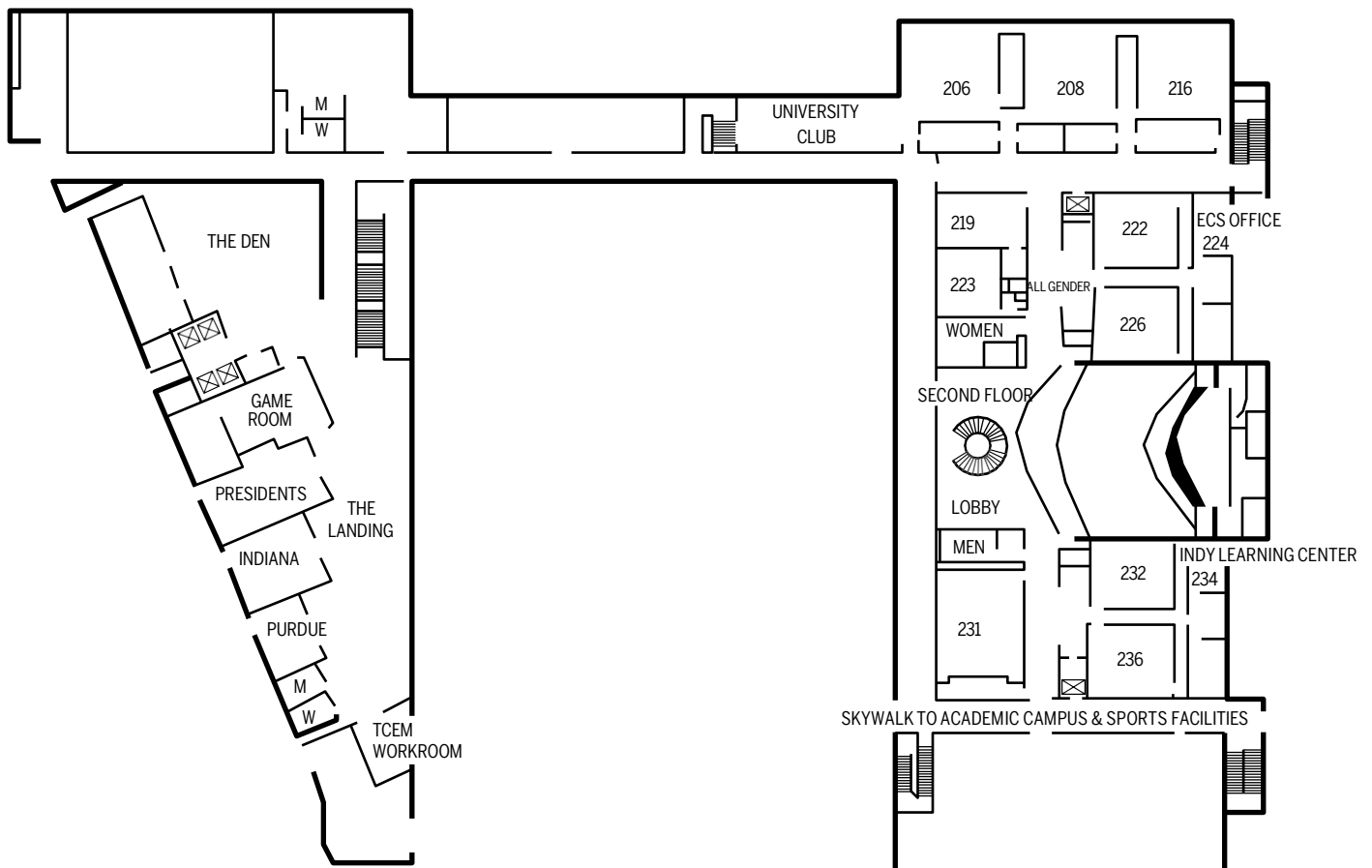

Follow us on 

**#IUSMEDDay2025**



**INDIANA UNIVERSITY**  
SCHOOL OF MEDICINE